

Master of Science (MSc)
**Socio-Ecological
Economics and Policy**

WU
WIRTSCHAFTS
UNIVERSITÄT
WIEN VIENNA
UNIVERSITY OF
ECONOMICS
AND BUSINESS



“There are very few development issues that are not hugely affected by a rapidly changing environment and cross-sectoral influences. We do not have the luxury any more to look at a program only from a technical and/or political perspective. Understanding demographic developments, the increasing influence of civil society, climate impacts, international negotiations over global goods, financial liquidity and feasibility, etc. is much more important for our programs today than understanding infra-structure, water engineering or health care, which seem to be job descriptions of the past. This is why, to us, the new MSc Socio-Ecological Economics and Policy at WU looks very interesting and relevant for addressing key sustainability issues.”

WERNER L. KORNEXL, SENIOR CLIMATE CHANGE SPECIALIST, WORLD BANK

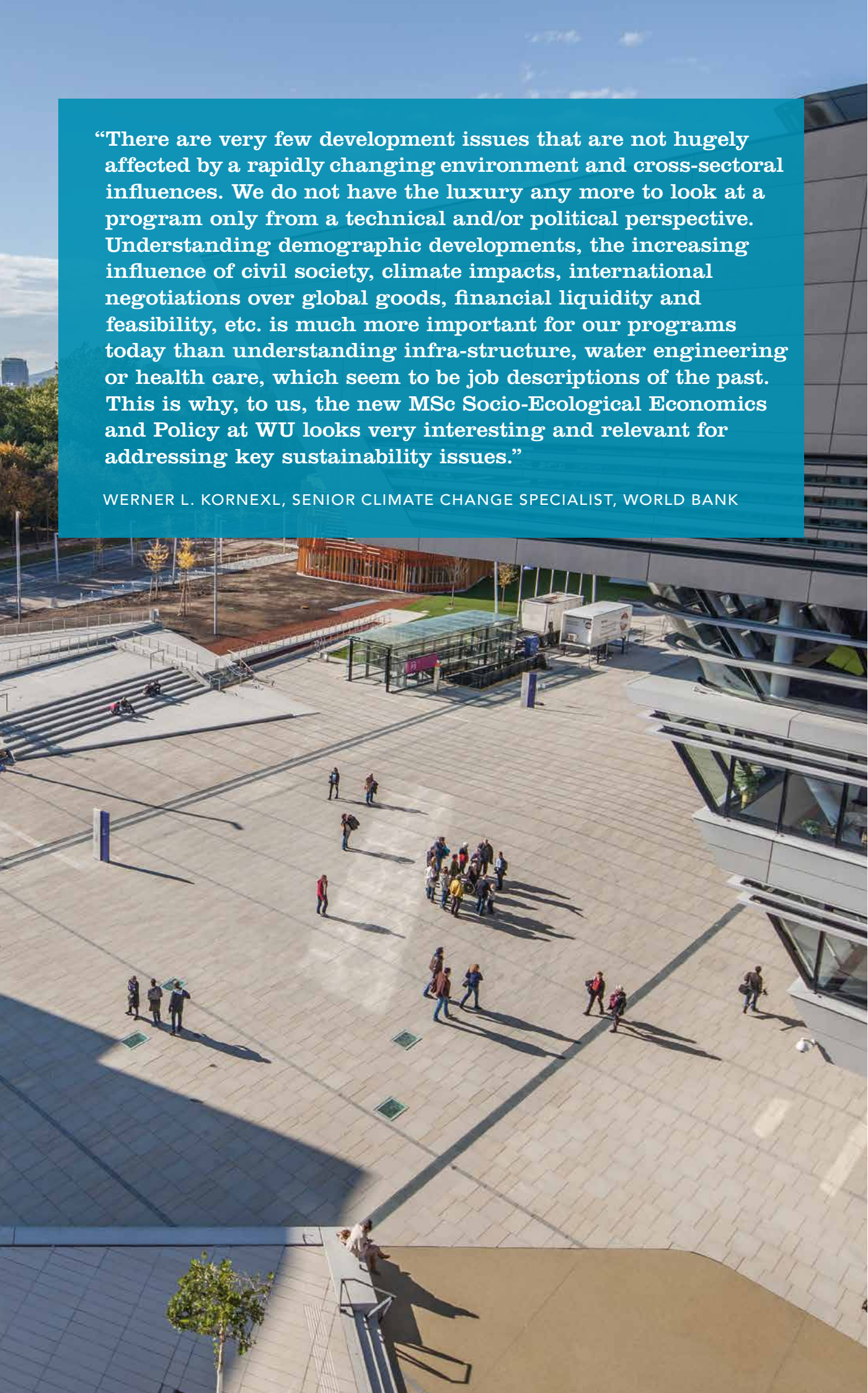

Welcome to WU

DEAR PROSPECTIVE STUDENTS,

The program offers training in socioeconomic analysis and focuses on the interfaces between economic, environmental, and social challenges. This interdisciplinary and internationally oriented approach builds upon three major pillars: theory, method, and application. The theory courses include concepts from different disciplines, selected for their content and suitability for studying global challenges. The method courses offer an integrated introduction to qualitative and quantitative methods and thus illustrate how they can be combined in empirical analyses. Relevance for policy making and organizational practice is emphasized throughout the program.

Developing new and innovative policy responses to global change demands approaches that include historic, descriptive, and institutional analyses as well as an understanding of legal frameworks and modes of governance. In particular, theories, methods, and analyses are brought together in two areas of concentration, which students select out of four subject areas.

Open to a select group of students from all over the world, this program combines academic excellence with practical and political relevance. The program is aimed at students with a diverse array of backgrounds, who have a deep concern for the challenges arising from rapid environmental change, population dynamics, poverty, and exclusion, and are keen to find ways to enhance environmental sustainability and human well-being.

I look forward to welcoming you to our program!

Sigrid Stagl

Program Director Socio-Ecological Economics and Policy



MSc Socio-Ecological Economics and Policy

AT A GLANCE

Duration	Four semesters, full-time degree program
Credits	120 ECTS credits (incl. 20 ECTS credits for the master's thesis)
Language of instruction	English
Degree awarded to graduates	Master of Science (WU)
Start	Every winter semester
Capacity	Up to 60 students per academic year
Application	Rolling admissions start every year in September
Contact	seep@wu.ac.at



Contents and Structure

This internationally unique program offers an integrated approach to studying the working of the human-environment system.

Rapid environmental change, population dynamics, poverty, and exclusion are interrelated processes that challenge human development. To tackle these complex issues, traditional disciplinary approaches to analysis and policy formulation are not sufficient. Instead, integrated and interdisciplinary approaches to studying the working of the human-environment system are needed.

This program presents integrated approaches to development and human well-being that go beyond the usual polarization between socioeconomic development and environmental goals.

SEEP (Socio-Ecological Economics and Policy) is an innovative, internationally unique program that equips participants with the necessary theoretical background and factual information about the interconnected dynamics of economic and social systems and the physical environment. Even more progressively, the program enables participants to understand different problem framings and use appropriate analytical tools to engage in decision processes and longer-term policy on multiple spatial levels. The strong interdisciplinary background acquired in SEEP provides graduates with the skills to play a leading role in resolving the critical economic, environmental and social problems of the 21st century.



“The great societal challenges of our time require an interdisciplinary approach and the ability to integrate different areas and methods. The MSc Socio-Ecological Economics and Policy at WU seems to equip graduates with this ability, combined with sound economic expertise. This is exactly what international and European organizations, including the European Commission, need.”

Martin Büchele, working for the
European Commission, DG Environment



The main elements of the SEEP curriculum are:

- › A conceptual framework for understanding global economic, environmental and social change,
- › Sophisticated skills in socioeconomic analysis, and qualitative as well as quantitative methods,
- › Concentration areas in
 - › Environmental Change and Policy
 - › Globalization and Multi-Level Policy
 - › Globalization and Social Policy
 - › Population, Human Capital, and Policy
- › An ability to apply skills and expertise to difficult and complex "real world" problems.

FIRST YEAR

At the beginning, students study global challenges and socioeconomic theories in detail. Besides acquiring basic methodological skills, SEEP students obtain solid knowledge about the philosophical dimensions of economics. They become familiar with the underlying assumptions and social paradigms that underlie economic policies and are reproduced by institutional actors.

The socioeconomic theories cover (1) macroeconomics, enriched by concepts on well-being and development; (2) behavioral economics and institutional economics of action; and (3) relevant legal frameworks and modes of governance from an institutional economic and public law perspective. During the second semester, students gain a profound understanding of their two chosen concentration areas.

SECOND YEAR

Students advance quickly to specialized expertise and real-world applications. In this phase, the main courses are in the concentration areas and students explore the interdependencies between these areas. Students develop and hone their research skills through course work and writing a thesis.

For details about the program structure, please visit our website:

wu.at/seep-structure





PROGRAM CURRICULUM¹

1st semester

Contemporary Global Policy Challenges	Methodology for Interdisciplinary Research	Growth, Well-Being, and Development	International Institutions, Governance, and Policy Evaluation	Service Learning 1
8 ECTS each				2,5 ECTS

2nd semester

Actors, Behaviors, and Decision Processes	Qualitative and Quantitative Methods	Concentration Area 1 ²	Concentration Area 2 ²	Service Learning 2
8 ECTS	10 ECTS	5 ECTS	5 ECTS	2,5 ECTS

3rd semester

Qualitative and Quantitative Methods 2	Concentration Area 1 (Part 2)	Concentration Area 2 (Part 2)
10 ECTS each		

4th semester

Research Seminar	Master's Thesis
5 ECTS	20 ECTS

¹ For details see: wu.at/seep

² Concentration Areas (choice of two): Environment, Population, Multi-Level Policy, Social Policy

International Orientation

Solid knowledge in theory combined with excellent methodological skills, together with a focus on the policy dimension of socio-ecological transitions, make the SEEP program internationally unique. Hence, we expect students to spend all four semesters of their studies at the WU to guarantee that they participate in all courses, workshops, and extra-curricular activities offered and are thoroughly trained in the methods and theories taught in the SEEP program.

Our main focus is on providing a thorough internationalization at the home university by attracting a diverse set of students from all over the world. The “international classroom at home” thus created is meant to allow students to experience foreign (academic) cultures, languages (especially English), and an international faculty without having to leave the campus. Guest lectures and research seminars with internationally renowned scholars complement the international character of the program.

For students who wish to gain experience abroad, 2 exchange spots per cohort are offered at the University of Illinois at Urbana-Champaign. These spots, available every winter term, are exclusively reserved for SEEP students.

Additionally, we offer our students the opportunity to write their master’s thesis with the NEURUS program, which is an international consortium of universities dedicated to the collaborative study of urban and regional development issues. Financial support may be granted to academically outstanding students to encourage them to deepen their knowledge through summer schools, conferences, and workshops abroad.

More information can be found on our website and on the WU’s International Office website: wu.ac.at/io/en

EXCHANGE OPPORTUNITIES AT A GLANCE			
Semester	Program/University	Country	Good to know
3rd semester (winter term)	University of Illinois at Urbana-Champaign	USA	2 spots per cohort
4th semester (summer term)	NEURUS program in spatial economics	worldwide	Combined with master thesis research



Program Faculty

FACULTY

DEPARTMENT OF SOCIOECONOMICS

Viviana Asara, Ecological Economics, Political Ecology, Democracy

Marcel Bilger, Econometrics, Behavioral Economics

Martin Bruckner, Industrial Ecology, Environmental Accounting, Land Use

Emanuele Campiglio, Ecological Economics, Climate Economics

Jürgen Essletzbichler, Economic Geography, Evolutionary Economics, Geography of Inequality

Wolfgang Fellner, Evolutionary and Institutional Economics

Barbara Haas, Care Policy and Gender

Endale Birhanu Kebede, Demography, Education, Sustainability

Wolfgang Lutz, Demography, Education, Sustainability

Verena Madner, Sustainable Urban Development and Urban Governance

Irene Monasterolo, Climate Economics and Finance

Asjad Naqvi, Ecological Economics

Andreas Novy, International Development, Sustainability

August Österle, Social Policy, Health Economics

Christian Rammel, Ecological Economics, Resilience, Education for Sustainability

Astrid Rennerstorfer, Social Policy

Armon Rezai, Ecological Economics, Macroeconomics

Ulrike Schneider, Social Policy, Economics of the Elderly

Manuel Scholz-Wäckerle, Evolutionary Political Economy, Agent-Based Modeling

Clive Spash, Social Ecological Economics, Public Policy

Sigrid Stagl, Program Director, Ecological Economics

Maria Rita Testa, Demography, Fertility, Sustainability

PROGRAM MANAGEMENT

Dorothy Kopel, Program Coordinator



Qualification Profile and Career Prospects

The program has been designed to provide students with the necessary understanding of global sustainability issues, an ability to work in interdisciplinary teams, and sound training in socioeconomic concepts and methods.

SEEP graduates:

- › Are equipped with the theories, methods and empirical approaches necessary for an in-depth understanding of global social, economic and environmental policy issues
- › Are aware of the variety of ethical issues arising from sustainable development
- › Possess the skills essential for interdisciplinary analysis
- › Can work in international teams in developing, designing and evaluating novel policy responses

The MSc program prepares graduates for:

- › Employment as policy analysts, program managers, consultants, civil servants, project managers, and advisors who provide an insight into and support decision processes relating to sustainability issues by, for example, undertaking risk and uncertainty analyses in the

social and environmental sectors; analyzing long-term developments relating to climate change, population development or aging in society; undertaking sustainability appraisals at company, regional or policy levels; helping design social, environmental, economic or educational policies; designing and facilitating participatory processes

- › Work in international organizations, consultancies, companies, ministries, national and international NGOs, and research institutes where interdisciplinary skills and knowledge about the interactions of sustainability issues are needed
- › Doctoral studies in the social sciences, in particular in economics, social policy, environmental studies and demography



Program Application Criteria

Before being admitted to the program, candidates are subject to a comprehensive and competitive selection process. We are looking for ambitious, highly motivated students with outstanding qualifications and excellent social skills.

You must meet the following minimum requirements to be eligible to apply:

Completion of or enrollment in a relevant bachelor program or other equivalent degree program at a recognized Austrian or international post-secondary institution. To be considered relevant, the program must meet the following criteria:

- › The program must be worth at least 180 ECTS credits
- › At least 16 ECTS credits must be from any one of the following subjects: economics, other social sciences, or statistics/mathematics/quantitative methods

The selection process consists of a combination of essays, a statement of motivation, reference letters, and an interview. For more details about application proceedings (minimum requirements, rolling admissions policy, etc.), please visit our website wu.at/seep

SEEP STUDENTS 2018

Average age: 25.6 years old

48% female

73% international students (non-Austrian)



Application and Admission to WU

Selection procedures apply for all English-taught MSc programs. WU employs a rolling admissions policy with three priority deadlines.

APPLICATION

To keep quality standards high, all of WU's English-taught MSc programs have a limited number of places available and a comprehensive selection process is in place. The first step is an online application. WU's rolling admissions policy allows students to apply from the beginning of September until spring and gives students the opportunity to apply early and secure a place in the WU program of their choice. The three priority deadlines are October 8th, January 8th, and March 8th (March is not applicable for International Management/CEMS). The specific selection process varies by program.

PROFICIENCY IN ENGLISH

Applicants must provide proof that they have a sufficient command of the English language, e.g. TOEFL 100, IELTS 7.0, CAE Certificate in Advanced English, English as a first language, or a full English-taught bachelor's program (at least 3 years) or master's program (at least 2 years).

ADMISSIONS

Successful applicants who have received an admission offer must enroll in person at WU's Admissions Office.

Detailed information on the admission requirements and the application procedures for the English-taught master's programs is available online: wu.at/application-guide





ACADEMIC CALENDAR

At WU, the academic year is divided into two semesters. The winter semester starts in October and ends in February. It is followed by the summer semester, which runs until the end of June. Summer break is in July, August, and September. All English-taught master's programs start in the winter semester.

Detailed information on enrollment deadlines and WU's academic calendar can be found on the WU website at [wu.at/academic-calendar](https://www.wu.ac.at/academic-calendar)

TUITION FEES

No tuition fees apply for EU, EEA, and Swiss citizens during the standard duration of their program (plus two extra semesters). All those exceeding the standard duration, however, are required to pay a tuition fee of approximately €360 per semester. Non-EU students are required to pay €727. Under certain circumstances, the same regulations that apply to EU, EEA, and Swiss citizens may apply to other students as well.

To find out more, please see [wu.at/fees](https://www.wu.ac.at/fees)

SCHOLARSHIPS

WU offers two financial aid programs that provide need-based and merit-based scholarship grants.

For further information, please contact WU's Study Regulations Office: [wu.at/study-service](https://www.wu.ac.at/study-service)

For other scholarship options, visit the Austrian Database for Scholarships and Research Grants (OeAD) at: [grants.at/en](https://www.grants.at/en)

ORGANIZING YOUR STUDIES AT WU

› Getting started

WU offers comprehensive information for international students on its website.

› Housing

International students coming to Vienna can choose from various housing options.

› Online services

A wide selection of online services is available to students on WU's website [wu.ac.at](https://www.wu.ac.at) and WU's learning and information portal **LEARN**.

› The Austrian Students' Union at WU

The Austrian Students' Union (ÖH) represents the interests of all WU students and offers them a wide spectrum of services.

› Student jobs at WU

WU students have many opportunities to actively participate in student and campus life. They may, for instance, choose to become course tutors, join one of our academic units as student staff members, or get involved with the Students' Union.

› Centrally located

WU is easily accessible by public transportation, and only a few minutes away from the city center.

WU Key Data

2018/19

Students

Total students (2018/19 winter semester)	22,016 (48% women)
International students (2018/19 winter semester)	6,023 (49% women)
Incoming exchange students	~1,000 per year
Outgoing exchange students	~1,000 per year

Faculty and Staff¹

Total faculty ²	497 (50% women)
Administrative staff	513 (85% women)
Total	1,147 (64% women)

Campus Resources

Premises Campus WU	100,000 m ²
Premises Library	
Total floor space	7,200 m ²
Volumes	~658,400

International

Partner universities	~240
Courses in English	~450/Semester

Graduate-Programs

German-taught master's programs

- › Business Education
- › Business Law (LL.M.)
- › Export and Internationalization Management
- › Finance and Accounting
- › Management
- › Socioeconomics
- › Taxation and Accounting

German-taught doctoral/PhD programs

- › Doctoral Program in Business Law (Dr. iur.)
- › Doctoral Program in Social and Economic Sciences³
- › PhD in Economic and Social Sciences³

English-taught master's programs

- › Economics
- › Information Systems
- › International Management/CEMS
- › Marketing
- › Quantitative Finance
- › Socio-Ecological Economics and Policy
- › Strategy, Innovation, and Management Control
- › Supply Chain Management

English-taught doctoral/PhD programs

- › PhD in International Business Taxation
- › PhD in Finance

¹⁾ full-time equivalents in 2018

²⁾ not including personnel funded by third parties

³⁾ English track available

English-Taught Master's Programs

Duration: 4 semesters; full-time programs;
120 ECTS credits; degree awarded: MSc (WU)

PROGRAM DETAILS

Economics

- › Focus on analyzing economic policy and business problems with state-of-the-art theories and methods
- › Applied Track and Science Track
- › 11 areas of specialization, many attractive international partner programs.

Information Systems

- › Focus on IT-related knowledge with a particular emphasis on management and research topics
- › Students acquire skills ranging from system analysis to system implementation
- › Based on state-of-the-art research

International Management/CEMS

- › Joint program: MSc (WU) and CEMS MIM degrees
- › Focus on international strategy and cross-cultural management
- › Internship abroad, business project, and exchange semester

Marketing

- › Focus on customer-oriented management concepts, marketing research, and decision tools
- › Qualifications for marketing specialist/executive positions, academic careers & advanced management consulting with a wide choice of marketing electives
- › Double degree with University Bocconi (5 slots)

Quantitative Finance

- › Focus on building strong quantitative skills coupled with a solid knowledge base of the underlying theory of finance
- › Students can choose between an Industry Track or a Science Track
- › Strong networks and links to the finance industry

Socio-Ecological Economics and Policy

- › Focus on socioeconomic analysis of sustainability issues
- › Students choose two of four concentration areas in the fields of Environment, Population, Multi-Level Policy, and Social Policy

Strategy, Innovation, and Management Control

- › Optional double degree in cooperation with selected partner schools
- › Focus on all major aspects of organizational leadership, as well as corporate development and strategic management
- › Case studies, business projects, and exchange semester

Supply Chain Management

- › Focus on design and analysis of supply chains for focal companies
- › Management and coordination of global supply chains
- › Learn to measure, evaluate, and control the quality of supply chain processes
- › Discussions of recent issues in SCM with industry experts

For further details see:
[wu.at/master-en](https://www.wu.at/master-en)

WU International

WU is a truly international university. It has recognized the necessity of thinking beyond Austria's borders early on. The international outlook of WU's teaching and research activities is a number one priority.

CONFIRMED QUALITY

Becoming one of the world's top business and economics universities has always been a high priority at WU. With its prestigious international accreditations, WU has achieved this goal. Fewer than 1% of universities worldwide can claim triple accreditation by EQUIS, AACSB, and AMBA, the three most well-respected accreditation agencies. WU is one of only six universities in the German-speaking world to belong to this exclusive group of schools.

WU is also a member of respected associations like CEMS (Global Alliance in Management Education), an alliance of 32 top business schools and more than 70 of the world's leading multinational companies ([cems.org](https://www.cems.org)), and PIM (Partnership in International Management), a network of 65 highly renowned business schools and universities around the globe ([pimnetwork.org](https://www.pimnetwork.org)).

RANKINGS

International ratings like the Financial Times Ranking have repeatedly positioned WU and its programs among the top universities in its field, and document WU's continuous progress each year ([rankings.ft.com](https://www.rankings.ft.com)).

STUDY AROUND THE GLOBE

WU has successfully integrated many international aspects in its research and teaching over the past few years. WU maintains a strong international network with around 240 partner universities all over the world, 130 of them offering exchange places for master students. Today WU is involved in numerous externally funded international research projects and has increased the number of its faculty members with international backgrounds, especially over the last few years.

INTERNATIONAL STUDENTS

As a result of these efforts, WU has a high percentage of international students: Today, more than one out of every four WU students comes from outside of Austria (not including exchange students). More than 110 nations are represented in WU's student population, with the majority of international students coming from countries in Europe. Together with around 1,000 exchange students, they contribute to the international and diverse atmosphere at WU.



Living in Vienna

Vienna is consistently ranked the city with the world's highest quality of living according to Mercer's Quality of Living Ranking.

HOUSING

WU has no on-campus dormitories or housing services. Still, international students can choose from various housing options:

› Student dormitories:

WU cooperates with the OeAD Housing Office to guarantee a limited number of places in student dormitories (housing.oead.at/en). Other providers include: [stuwo.at](https://www.stuwo.at), [wihast.at](https://www.wihast.at), [akademikerhilfe.at](https://www.akademikerhilfe.at), [milestone.net](https://www.milestone.net), [linked-living.com](https://www.linked-living.com)

› Private accommodation:

WU recommends [housinganywhere.com](https://www.housinganywhere.com), a peer-to-peer platform for finding private student apartments.

WORKING IN VIENNA

WU's ZBP Career Center is the first place to go for any questions regarding working in Austria ([zbp.at](https://www.zbp.at)).

- › Job openings for students, graduates and young professionals
- › Approx. 3,000 job vacancies per year
- › Approx. 1,800 CV checks, coachings and career advice

Please note that good German language skills are often required for jobs or internship positions in Vienna, both at local and international companies.

LIVING COSTS

Life in Vienna is quite affordable, especially for a capital city

Housing
approx. €400–600 per month

Health insurance
approx. €60 per month

Essentials (food, personal expenses)
approx. €300 per month

Public transportation
approx. €150 per semester

Books
approx. €75–150 per semester

Communications
approx. €15–30 per month

Entertainment
approx. €50–150 per month



University of the Future

Internationalism, innovation, diversity – Campus WU is the concrete realization of WU's vision for a modern university. The fundamental principles of the architecture reflect the values and ideas we cherish at WU.

In October 2013, WU relocated to an impressive new campus in Vienna's 2nd district. As a public institution, WU is aware of its responsibility, and built its campus in an economical, ecological, and socially sustainable manner. We have not only constructed new buildings, but in the process we have also given concrete realization to our ideas of what the university of the future should look like. The campus is more than just a place for academic research and teaching and learning practical skills; it is also designed to create a new space for social, cultural, and political life.

The imposing Library & Learning Center (LC), designed by the Iraqi-British architect Zaha Hadid, is a testament to the central importance of research and teaching at WU. The Library & Learning Center is surrounded by six building complexes, including the Teaching Center, which houses most of WU's auditoriums. The Teaching Center is intended mainly for bachelor's degree students, while

the master's degree programs are taught primarily in the individual department buildings. The Executive Academy building is the home of continuing education and life-long learning programs. In this way, the various buildings and their functions reflect the three tiers of teaching and learning represented by the Bologna Process.

WU's department-based organizational structure was also a contributing factor. In its former location, various academic units were scattered across the district. Now they have been brought together in five department buildings, making life much easier for both students and faculty.

The campus infrastructure features auditoriums with state-of-the-art teaching equipment, including digital whiteboards. There are 3,000 student workplaces, located not only in areas intended for individual study, but also in project rooms that can be booked by teaching staff and

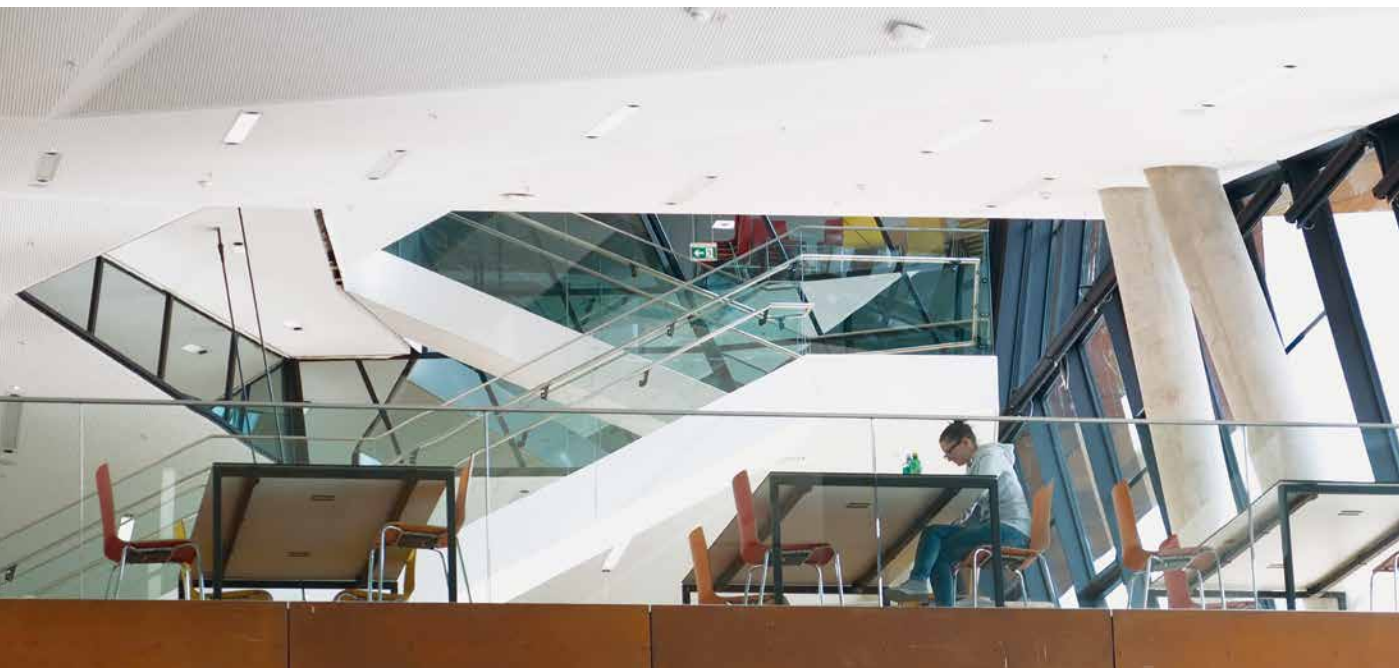



students alike. They cater to different needs by providing quiet spots for focused academic work as well as opportunities for work on group projects in communication-friendly study areas.

The campus provides an environment for WU students and staff that encourages productive work and communication. Not only the buildings themselves, but also the surrounding grounds offer plenty of opportunities for communication and meeting people. 55,000 m² of Campus WU's total surface area of 90,000 m² is open, publicly accessible space. Fences or barriers would contradict our vision of an open campus.

Visitors and area residents are more than welcome on Campus WU. The campus offers not only food for thought, but also restaurants, cafés, and shops, all in a stimulating architectural environment.

The campus is not only architecturally outstanding, the entire complex was also designed in accordance with "green building" principles. Much of the required energy is obtained using geothermal energy from groundwater, and "green IT" systems capture the heat from server facilities and recycle it back into the buildings' energy supply.

Another key feature of Campus WU is barrier-free accessibility. All auditoriums are specially equipped for people with disabilities, all areas are designed to be wheelchair accessible, and the campus also features a tactile guidance system for the visually impaired.

We have not only made sure to comply with all relevant legal guidelines, but we have also drawn on experience gained from best practice examples. WU aims to play a pioneering role – in all respects.

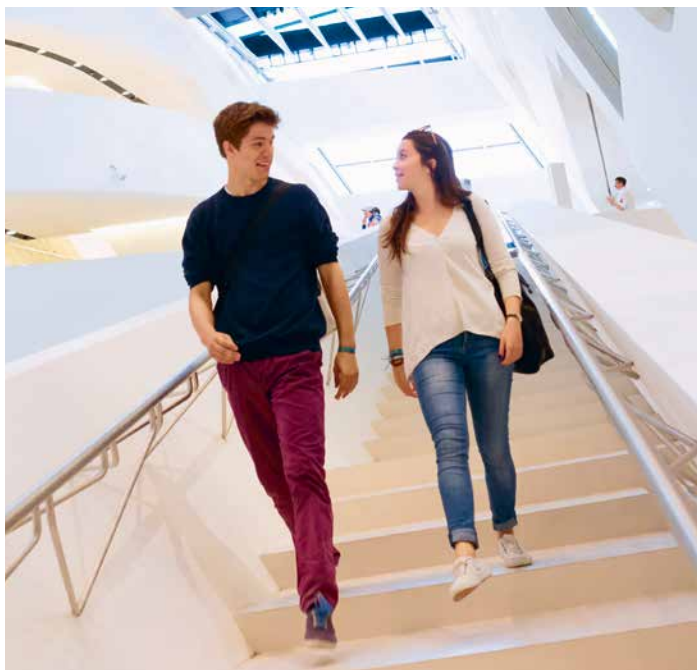

Information and contact

To find out more about the Master's Program in
Socio-Ecological Economics and Policy, please visit:
wu.at/seep

For content-related questions, please e-mail:
seep@wu.ac.at

Academic Director of the Master's Program in
Socio-Ecological Economics and Policy:
Sigrid Stagl



WU (Vienna University of Economics and Business)
Welthandelsplatz 1, 1020 Vienna, Austria
wu.ac.at

Arriving by public transport:
Subway: U2 stations "Messe-Prater" or "Krieau"
Bus: 82A, "Südportalstraße" stop